

PLASAUTO



Plastic Screws

Gears / Bushing / Threaded Rod

Plastic Products

Mold Design

Customized

www.plasautotw.com

Material Characteristics

PLASAUTO provides 11 kinds of materials, you have many choices among the materials according your needs.

Advanced Engineering Plastics

PEEK

PPS

PVDF

PEI

RENY

Engineering Plastics

PTFE

PC

POM

PA6

PA66

PP

Product Advantages

2 Nonmagnetic

Nonmagnetic body

1 Insulation

Greater electric resistance; exceptional insulation

Dielectric strength
RENY / 32MV/m

Object insulation resistance
PFA / $>10^{18}\Omega \cdot \text{cm}$

4 Light-weight

Only 1/5 - 1/6 of the weight of metal

Specific weight
SUS / 7.7 | Iron / 7.85
PC / 1.2 | PP / 0.91

3 Thermal insulation

Low thermal conductivity; excellent thermal insulation

Thermal conductivity

Iron	80.4 W/m·K
PC	0.19 W/m·K
RENY	0.55 W/m·K
PVDF	0.17 W/m·K

5 Anti-corrosion

Free of concern about rust and corrosion

Acid resistance

Caustic resistance

Organic solvents

Weather-proof

Polyetheretherketone / Advanced Engineering Plastics



Product Properties

1. Exceptional chemical resistance.
2. Very good abrasion resistance.
3. Best-in-class fatigue & creep resistance.
4. Excellent resistance to hydrolysis in boiling water and superheated steam.
5. Superior dielectric with low loss at the condition of high temperatures and high frequencies.

Applied Industries

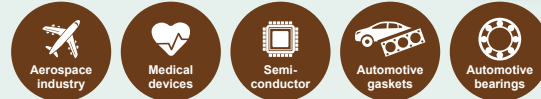

Polyphenylene Sulfide / Advanced Engineering Plastics



Product Properties

1. Outstanding long-term heat resistance properties (200-240°C).
2. Minimum molding contraction rate and low moisture absorption.
3. Outstanding chemical resistance.
4. High mechanical strength and rigidity. Outstanding anti-fatigue and anti-creep properties.
5. Flame retardant (UL94V-0 without inclusion of flame retardant agents)
6. Offers outstanding electrical properties at high temperature, high humidity and high frequencies.

Applied Industries

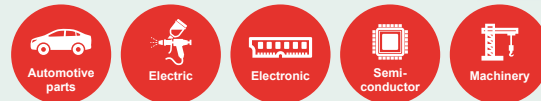

Fluorine Resin / Advanced Engineering Plastics



Product Properties

1. Excellent chemical resistance to most of aggressive solvents.
2. Excellent mechanical strength & high abrasion resistance.
3. Continuous use temperature up to 150°C.
4. Excellent ageing resistance.
5. Resistance to UV and nuclear radiations.
6. Excellent intrinsic fire resistance.

Applied Industries



Polyetherimide / Advanced Engineering Plastics



Product Properties

1. Dimensional Stability.
2. Long-term heat resistance.
3. Environmental & stress cracking resistance.
4. Low flammability, low smoke generation and toxicity.

Applied Industries



Polyamide MXD6 / Advanced Engineering Plastics



Product Properties

1. Excellent mechanical strength modulus over a wide range of temperatures.
2. Lower water absorption compared to general PA.
3. High heat distortion temperature, low thermal expansion coefficient, equivalent to metal alloys.
4. Excellent chemical resistance against oils and organic solvents.
5. Low molding shrinkage rate and low part warpage, suitable for molding precise articles.

Applied Industries

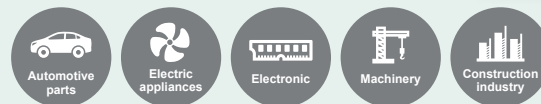

Polytetrafluoroethylene / Engineering Plastics



Product Properties

1. High heat resistance / good heat stability.
2. Excellent weathering resistance.
3. Low friction coefficient.
4. Superior electrical properties.

Applied Industries



Polycarbonate / Engineering Plastics

Product Properties

1. Good electrical insulation.
2. High strength to impact.
3. Flame retarding and UV-resistant.
4. Good dimension stability and light transmittance.

Applied Industries



PC



Polyacetal / Engineering Plastics

Product Properties

1. Low friction / Low wear.
2. Creep resistance / Fatigue resistance.
3. Chemical resistance, Fuel / Oil resistance.
4. Dimensional stability.

Applied Industries



POM



Polyamide 6 / Engineering Plastics

Product Properties

1. High mechanical strength, stiffness, hardness and toughness.
2. Good fatigue resistance.
3. High mechanical damping ability.
4. Excellent wear resistance.
5. Good electrical insulating properties.

Applied Industries

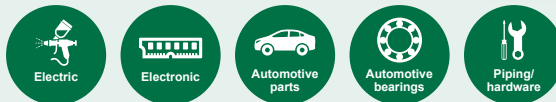

PA6



Polyamide 66 / Engineering Plastics

Product Properties

1. Slightly less moisture absorption ability.
2. Better wear resistance.
3. Better chemical resistance to acids.
4. Higher heat deflection temperature.

Applied Industries



PA66



Polypropylene / Engineering Plastics

Product Properties

1. Low cost and ease of molding.
2. Light specific weight and low water absorption.
3. Durability in appearance.
4. Chemical stability.
5. Versatile use on many parts.

Applied Industries

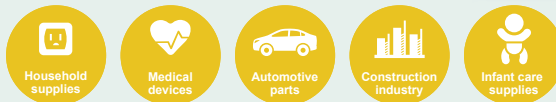

PP



Large screw set Custom products



PEEK Hex screw set (large)



POM Hex screw set (large)



PA Hex screw set (large)

Countersunk Phillips Screws

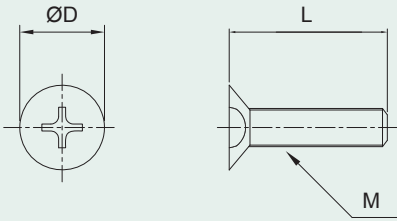

M	2	3	4	5	6	8
D	4	6	8	10	12	16
Pitch	0.4	0.5	0.7	0.8	1	1.25
L(mm)	4	•	•	-	-	-
	5	•	•	•	-	-
	6	•	•	•	-	-
	8	•	•	•	•	-
	10	•	•	•	•	•
	12	-	•	•	•	•
	15	-	•	•	•	•
	16	-	•	•	•	•
	20	-	•	•	•	•
	25	-	•	•	•	•
	30	-	-	•	•	•
	35	-	-	•	•	•
	40	-	-	•	•	•
45	-	-	-	-	•	

Buttonhead Phillips Screws

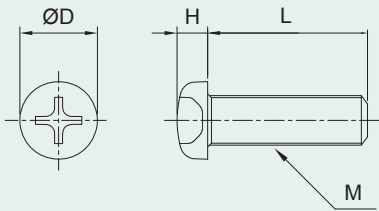

M	2	3	4	5	6	8
DxH	3.5x1.3	5.5x2	7x2.6	9x3.3	10.5x3.9	14x5.2
Pitch	0.4	0.5	0.7	0.8	1	1.25
L(mm)	4	•	•	-	-	-
	5	•	•	•	-	-
	6	•	•	•	•	-
	8	•	•	•	•	-
	10	•	•	•	•	•
	12	•	•	•	•	•
	15	-	•	•	•	•
	16	-	•	•	•	•
	20	-	•	•	•	•
	25	-	•	•	•	•
	30	-	-	•	•	•
	35	-	-	•	•	•
	40	-	-	•	•	•
45	-	-	-	-	•	
50	-	-	-	-	•	

Set Screws

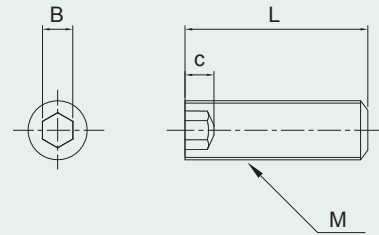

M	3	4	5	6	8
BxC	1.5x2	2x2.5	2.5x3	3x3.5	4x5
Pitch	0.5	0.7	0.8	1	1.25
L(mm)	4	•	-	-	-
	5	•	•	-	-
	6	•	•	•	•
	8	•	•	•	•
	10	•	•	•	•
	12	•	•	•	•
	15	•	•	•	•
	20	-	•	•	•
25	-	-	-	•	
30	-	-	-	-	

Nuts

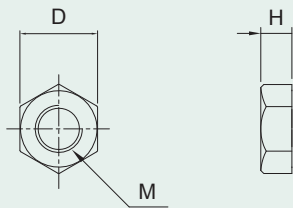

M	3	4	5	6	8	10	12
DxH	5.5x2.4	7x3.2	8x4	10x5	13x6.5	17x8	19x10
Pitch	0.5	0.7	0.8	1	1.25	1.5	1.75

Gaskets

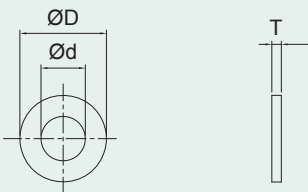

M	3	4	5	6	8	10	12
Dxd	7x3.2	9x4.3	10x5.3	12.5x6.4	17x8.4	21x10.5	24x13
T	0.5	0.8	1	1.6	1.6	2	2.5

Threaded Rod

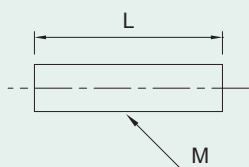

M	5	6	8	10	12	3/8-16UNC
Pitch	0.8	1	1.25	1.5	1.75	1.5875
L(mm)	1000	•	•	•	•	•
	1500	-	•	•	•	•

For any demand of special sizes, please contact us!

Specs

Hex Socket Screws

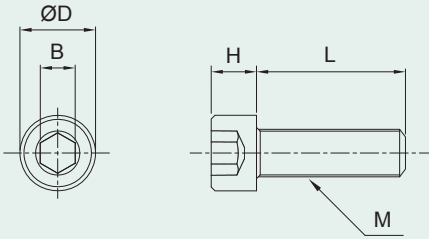

M	3	4	5	6	8
DxH	5.5x3	7x4	8.5x5	10x6	13x8
B	2.5	3	4	5	6
Pitch	0.5	0.7	0.8	1	1.25
L(mm)	4	•	-	-	-
	5	•	•	-	-
	6	•	•	•	-
	8	•	•	•	-
	10	•	•	•	•
	12	•	•	•	•
	15	•	•	•	•
	16	•	•	•	•
	20	•	•	•	•
	25	•	•	•	•
	30	-	•	•	•
	35	-	•	•	•
40	-	•	•	•	
45	-	-	-	•	
50	-	-	-	•	

Hex Socket - Embossing Screws

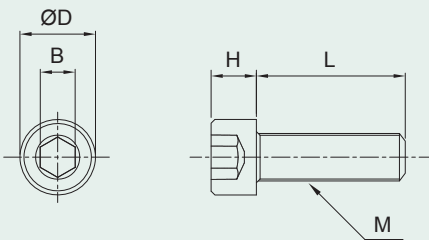

M	3	4	5	6	8	10	12
DxH	5.5x3	7x4	8.5x5	10x6	13x8	16x10	18x12
B	2.5	3	4	5	6	8	10
Pitch	0.5	0.7	0.8	1	1.25	1.5	1.75
L(mm)	4	•	-	-	-	-	-
	5	•	•	-	-	-	-
	6	•	•	•	-	-	-
	8	•	•	•	-	-	-
	10	•	•	•	•	-	-
	12	•	•	•	•	•	-
	15	•	•	•	•	•	•
	16	•	•	•	•	•	-
	20	•	•	•	•	•	•
	25	•	•	•	•	•	•
	30	-	•	•	•	•	•
	35	-	•	•	•	•	•
40	-	•	•	•	•	•	
45	-	-	-	•	•	•	
50	-	-	-	•	•	•	

Hex Head Screws

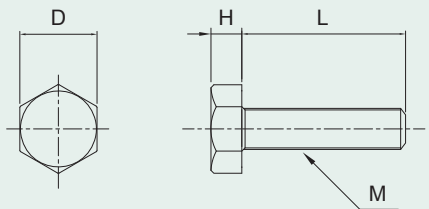

M	4	5	6	8	10	12
DxH	7x2.8	8x3.5	10x4	13x5.5	17x7	19x8
Pitch	0.7	0.8	1	1.25	1.5	1.75
L(mm)	4	-	-	-	-	-
	5	-	-	-	-	-
	6	•	•	-	-	-
	8	•	•	-	-	-
	10	•	•	•	•	-
	12	•	•	•	•	-
	15	•	•	•	•	•
	16	•	•	•	•	-
	20	•	•	•	•	•
	25	•	•	•	•	•
	30	•	•	•	•	•
	35	•	•	•	•	•
40	•	•	•	•	•	
45	-	-	•	•	•	
50	-	-	•	•	•	

Hex Head Slotted Screws

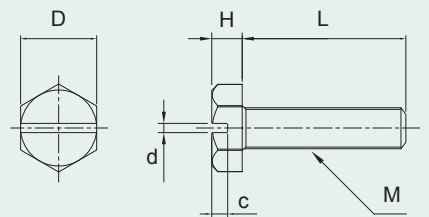

M	4	5	6	8	10	12
DxH	7x2.8	8x3.5	10x4	13x5.5	17x7	19x8
c	1.4	1.8	2.1	2.8	3.5	4
d	1	1.2	1.2	2.1	2.2	2.2
Pitch	0.7	0.8	1	1.25	1.5	1.75
L(mm)	4	-	-	-	-	-
	5	-	-	-	-	-
	6	•	•	-	-	-
	8	•	•	-	-	-
	10	•	•	•	•	-
	12	•	•	•	•	-
	15	•	•	•	•	•
	16	•	•	•	•	-
	20	•	•	•	•	•
	25	•	•	•	•	•
	30	•	•	•	•	•
	35	•	•	•	•	•
40	•	•	•	•	•	
45	-	-	•	•	•	
50	-	-	•	•	•	

Threaded Rod Customized Service

Material

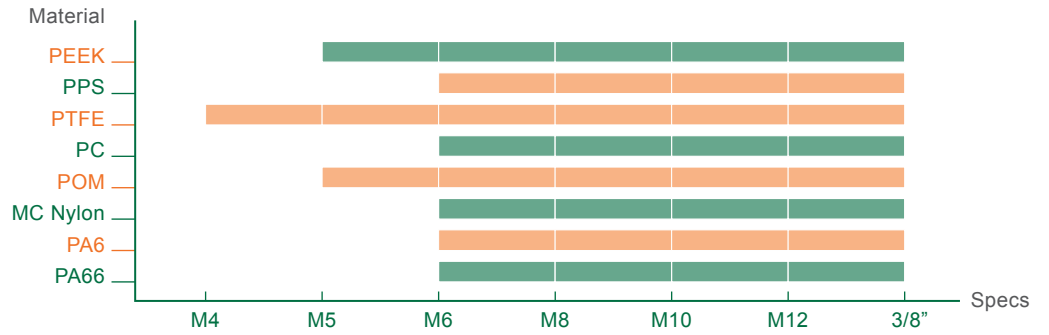

Products

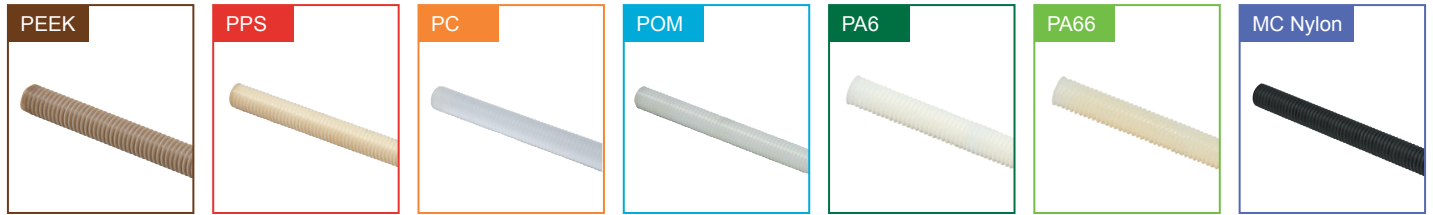

Gears Customized Service

Specs

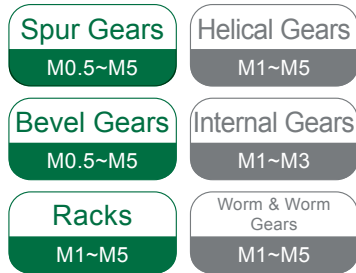

Material

Kinds

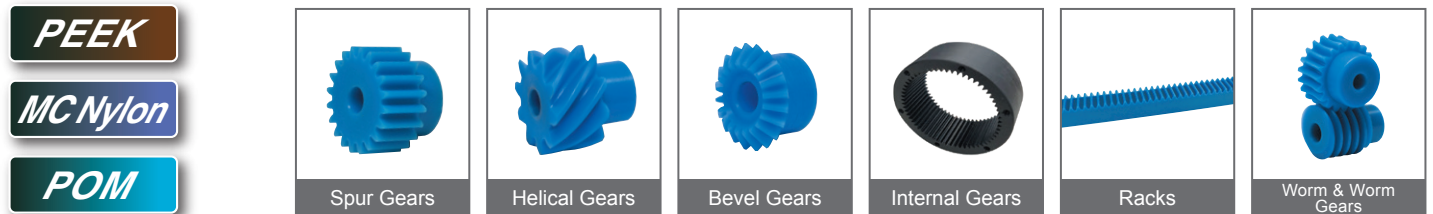

Bushing Customized Service

Material



Products



Others Customized Service

Products



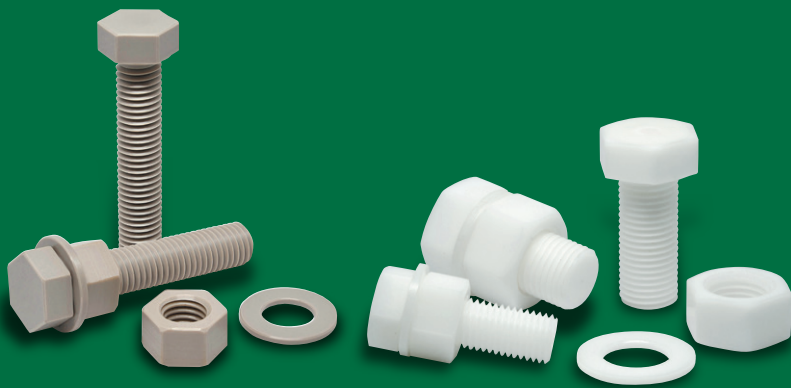

Never rust, Aesthetic and Durable

High temperature resistance, Chemical and Corrosion resistance, Extending equipment life.



PLASTIC AUTOMATION CO., LTD.

No.60-3, Dongqi 7th Ln., Lukang Township,
Changhua County 505008, Taiwan

TEL: +886-4-778-4688

FAX: +886-4-778-4268

E-mail: sales@plasautotw.com

www.plasautotw.com

