

# Hex Socket - Embossing Screws

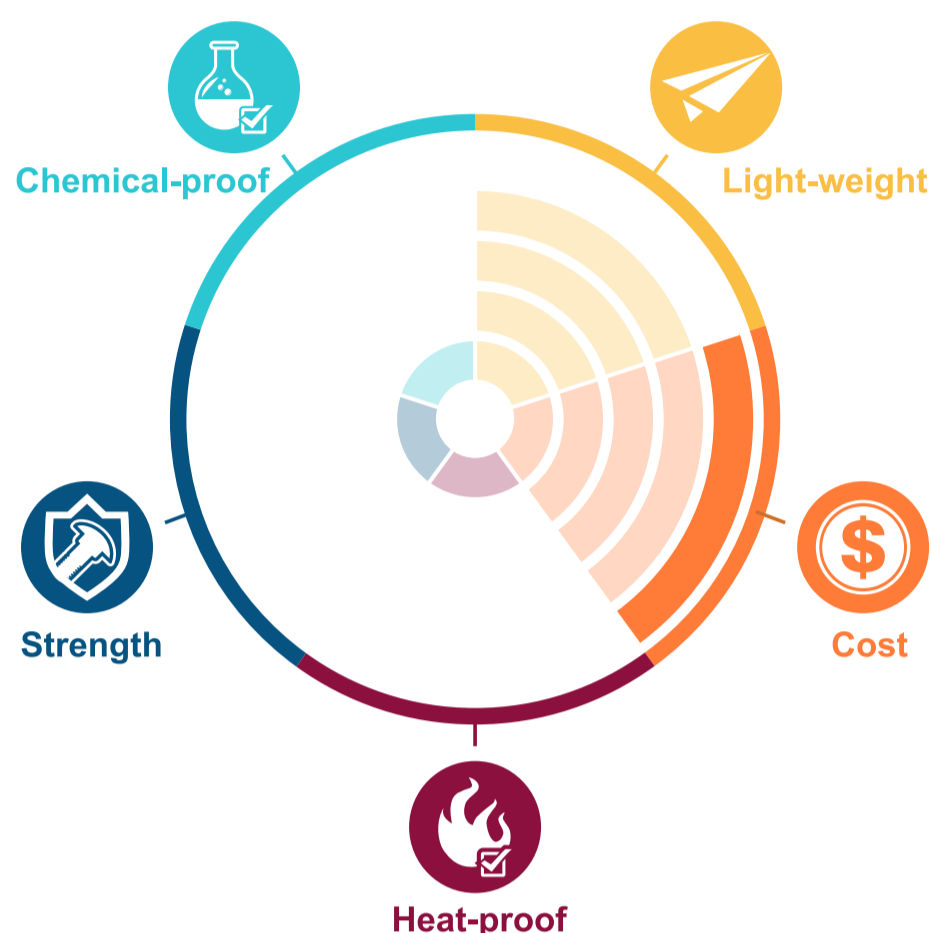

Model SCBFPA6M(-)(L)

**PA6** Polyamide 6 / Engineering Plastics



PA6 should be used if a lightweight engineering plastic is required to withstand high impact and stress. It has better aesthetic appearance than PA 66 due to its lustrous finish and is easier to be dyed. It is an ideal choice for applications in the automotive, industrial and military industries. It is not ideal, however, for applications that are exposed to water at high temperatures due to its higher water absorption and lower heat deflection rate than PA 66.

**Product Properties**

1. High mechanical strength, stiffness, hardness and toughness.
2. Good fatigue resistance.
3. High mechanical damping ability.
4. Excellent wear resistance.
5. Good electrical insulating properties.

**Applied industries**



**Specs**

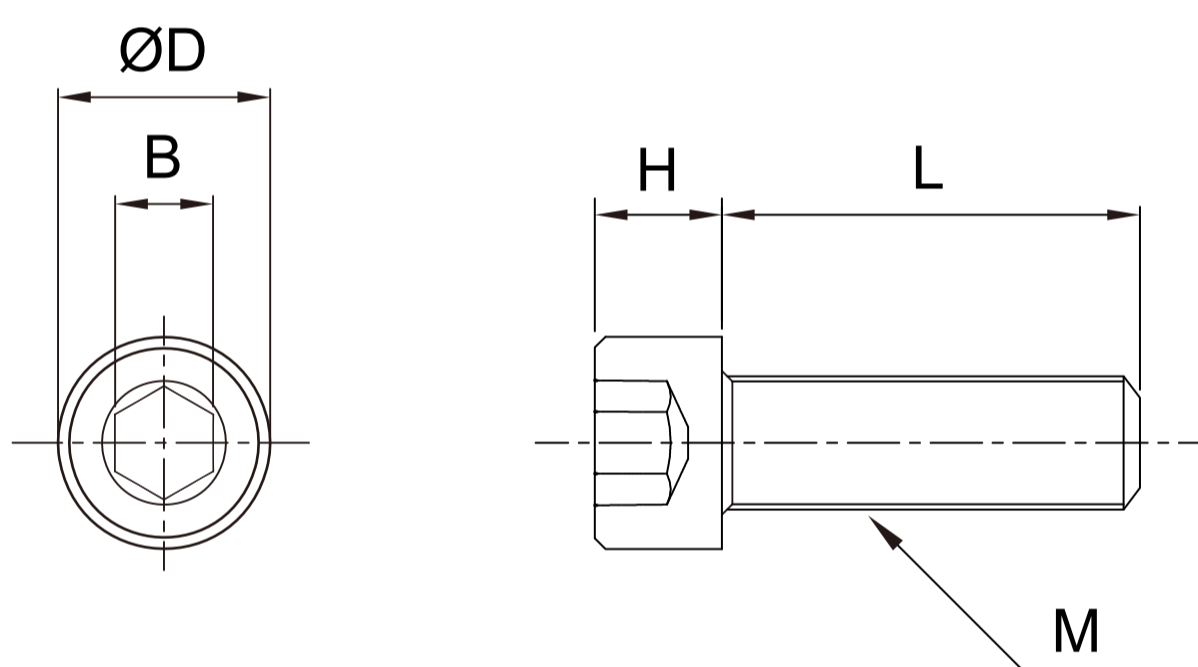

Model: SCBFPA6M(-)(L)

M	3	4	5	6	8	10	12
<b>DxH</b>	5.5x3	7x4	8.5x5	10x6	13x8	16x10	18x12
<b>B</b>	2.5	3	4	5	6	8	10
<b>Pitch</b>	0.5	0.7	0.8	1	1.25	1.5	1.75
<b>L(mm)</b>	4	•	-	-	-	-	-
	5	•	•	-	-	-	-
	6	•	•	•	-	-	-
	8	•	•	•	-	-	-
	10	•	•	•	•	•	-
	12	•	•	•	•	•	-
	15	•	•	•	•	•	•
	16	•	•	•	•	•	-
	20	•	•	•	•	•	•
	25	•	•	•	•	•	•
	30	-	•	•	•	•	•
	35	-	•	•	•	•	•
40	-	•	•	•	•	•	
45	-	-	-	•	•	•	
50	-	-	-	•	•	•	

**Contact Information**

No.60-3, Dongqi 7th Ln., Lukang Township, Changhua County 505008, Taiwan.  
 TEL: +886-4-778-4688  
 FAX: +886-4-778-4268  
 E-mail: sales@plasautotw.com

