

Hex Socket - Embossing Screws

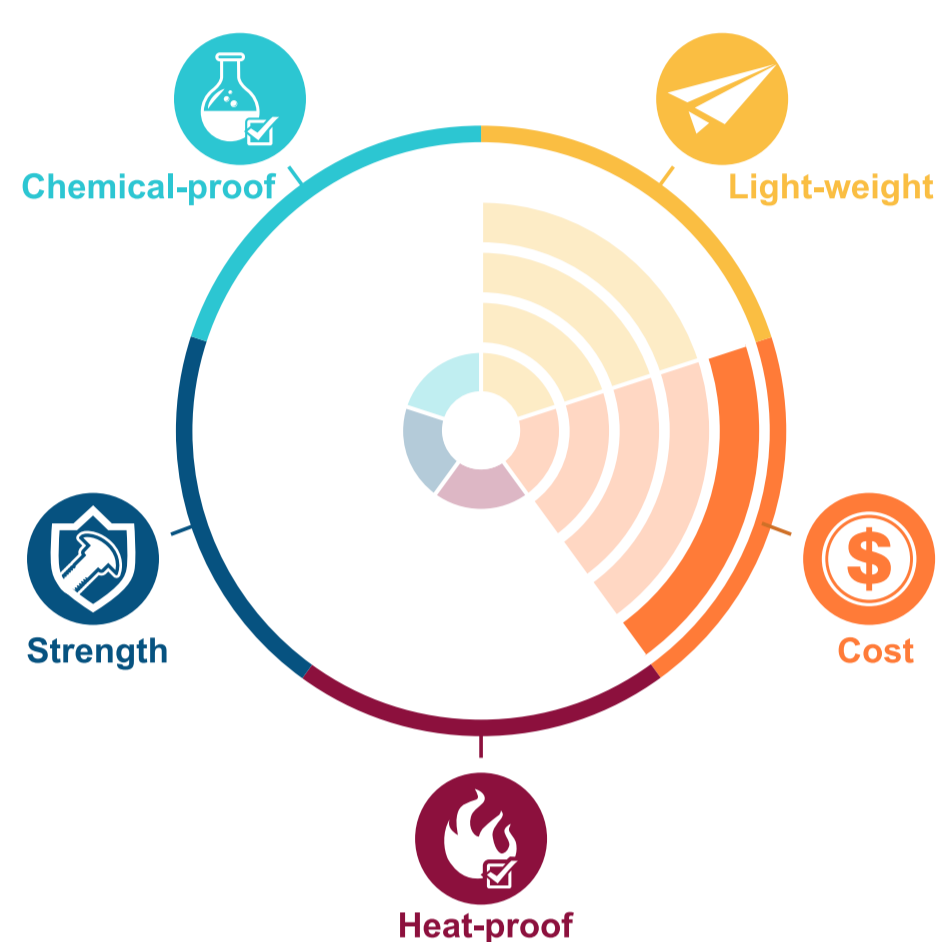

Model SCBFPAM()- (L)

PA66 Polyamide 66 / Engineering Plastics



Nylon 66 should be used if a part is required to be exposed to higher temperatures. Additionally, its stiffness and good tensile and flexural modulus make it an ideal material for applications that need a long-term repeating working condition. Typical application parts include: friction bearings, radiator caps and tire ropes.

Product Properties (compared to PA6)

1. Slightly less moisture absorption ability.
2. Better wear resistance.
3. Better chemical resistance to acids.
4. Higher heat deflection temperature.

Applied industries



Specs

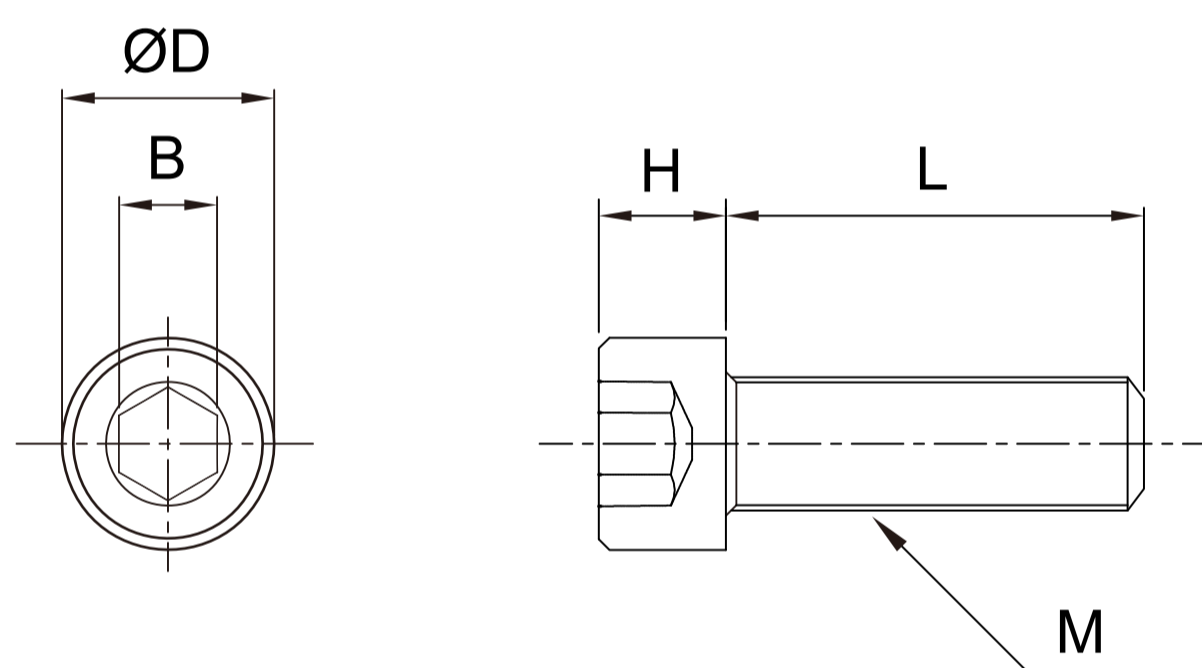

Model: SCBFPAM()- (L)

M	3	4	5	6	8	10	12
DxH	5.5x3	7x4	8.5x5	10x6	13x8	16x10	18x12
B	2.5	3	4	5	6	8	10
Pitch	0.5	0.7	0.8	1	1.25	1.5	1.75
L(mm)	4	•	-	-	-	-	-
	5	•	•	-	-	-	-
	6	•	•	•	-	-	-
	8	•	•	•	-	-	-
	10	•	•	•	•	•	-
	12	•	•	•	•	•	-
	15	•	•	•	•	•	•
	16	•	•	•	•	•	-
	20	•	•	•	•	•	•
	25	•	•	•	•	•	•
	30	-	•	•	•	•	•
	35	-	•	•	•	•	•
40	-	•	•	•	•	•	
45	-	-	-	•	•	•	
50	-	-	-	•	•	•	

Contact Information

No.60-3, Dongqi 7th Ln., Lukang Township, Changhua County 505008, Taiwan.
 TEL: +886-4-778-4688
 FAX: +886-4-778-4268
 E-mail: sales@plasautotw.com

