

# Buttonhead Phillips Screws



Model SPHPEIM( )-(L)

**PEI** Polyetherimide / Advanced Engineering Plastics



PEI is amorphous thermoplastic, high performance resins. It offers outstanding elevated thermal resistance, high mechanical strength, stiffness and dimensional stability over a broad temperature range, inherent flame resistance, hydrolytic stability, and broad chemical resistance.

**Product Properties**

1. Dimensional Stability.
2. Long-term heat resistance.
3. Environmental & stress cracking resistance.
4. Low flammability, low smoke generation and toxicity.

**Applied industries**



**Specs**

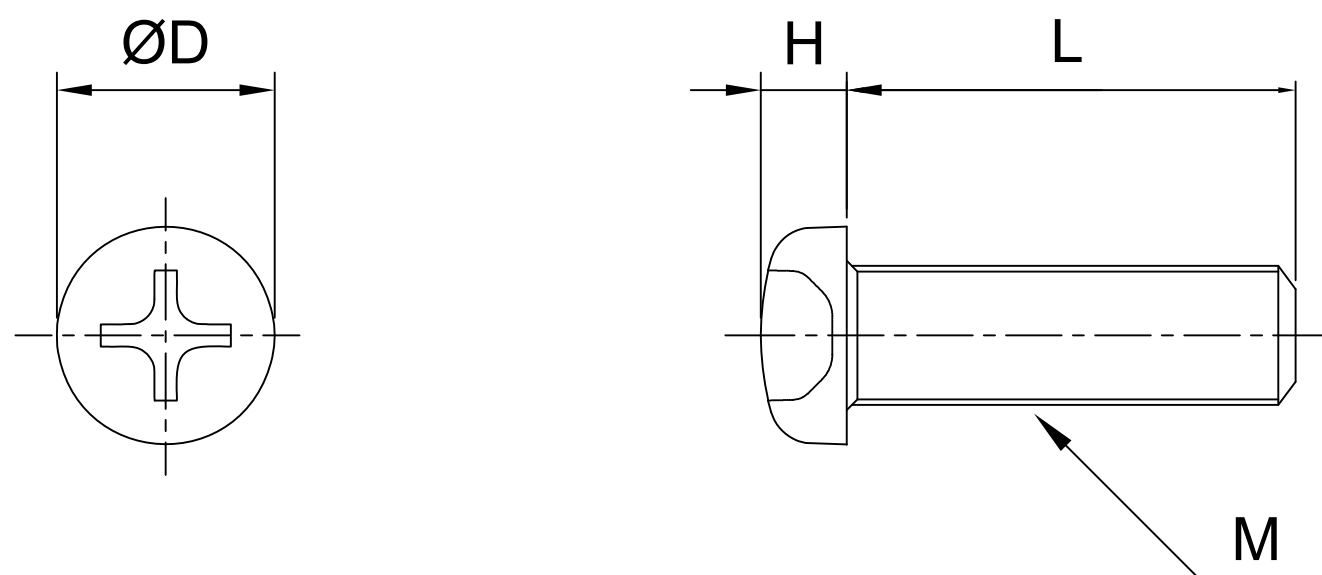

Model: SPHPEIM( )-(L)

M	2	3	4	5	6	8
<b>DxH</b>	3.5x1.3	5.5x2	7x2.6	9x3.3	10.5x3.9	14x5.2
<b>Pitch</b>	0.4	0.5	0.7	0.8	1	1.25
<b>L(mm)</b>	4	•	•	-	-	-
	5	•	•	•	-	-
	6	•	•	•	•	-
	8	•	•	•	•	-
	10	•	•	•	•	•
	12	•	•	•	•	•
	15	-	•	•	•	•
	16	-	•	•	•	•
	20	-	•	•	•	•
	25	-	•	•	•	•
	30	-	-	•	•	•
	35	-	-	•	•	•
	40	-	-	•	•	•
45	-	-	-	-	•	
50	-	-	-	-	•	

**Contact Information**

No.60-3, Dongqi 7th Ln., Lukang Township, Changhua County 505008, Taiwan.  
 TEL: +886-4-778-4688  
 FAX: +886-4-778-4268  
 E-mail: sales@plasautotw.com

