

Countersunk Phillips Screws

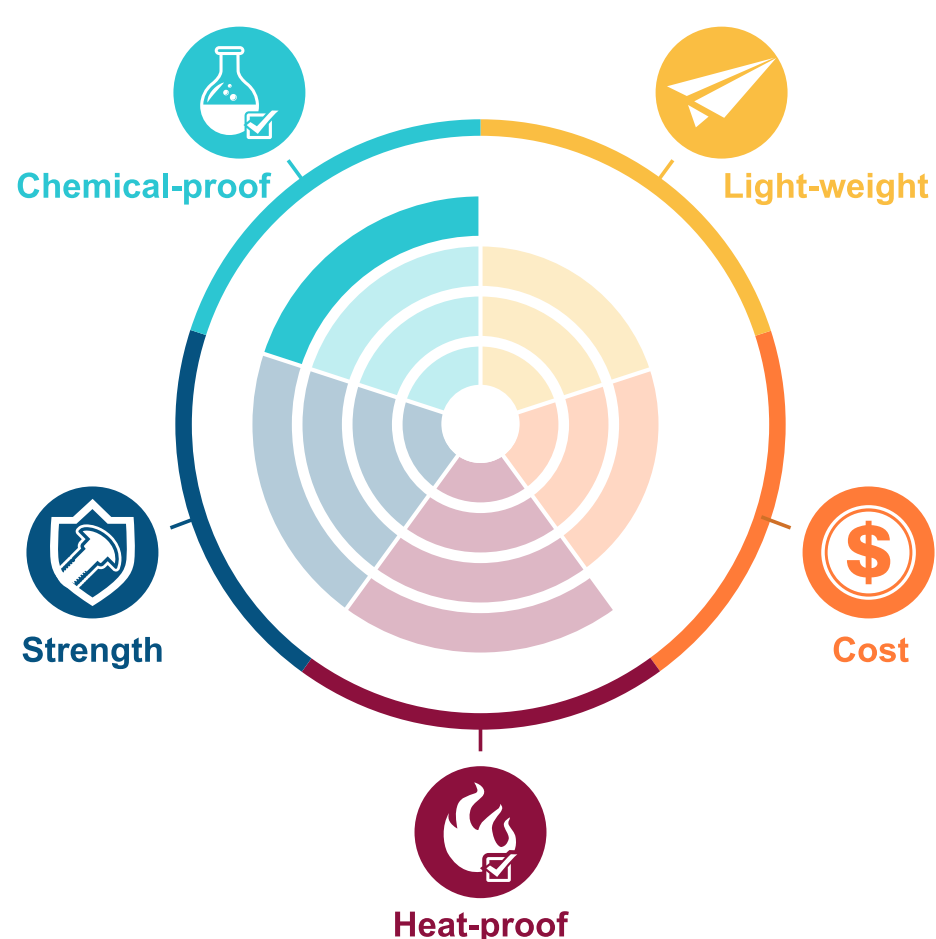

Model SFHPPSM()-(L)

PPS Polyphenylene Sulfide / Advanced Engineering Plastics



PPS is a kind of semi-crystalline, high-heat thermoplastic polymer that offers exceptional dimensional stability for precision-molded components needing to withstand prolonged, high-temperature service. Its inherently flame retardant and chemical resistance qualities make it competitive to PEEK and fluoropolymers.

Product Properties

1. Outstanding long-term heat resistance properties (200-240°C).
2. Minimum molding contraction rate and low moisture absorption.
3. Outstanding chemical resistance.
4. High mechanical strength and rigidity. Outstanding anti-fatigue and anti-creep properties.
5. Flame retardant (UL94V-0 without inclusion of flame retardant agents)
6. Offers outstanding electrical properties at high temperature, high humidity and high frequencies.

Applied industries

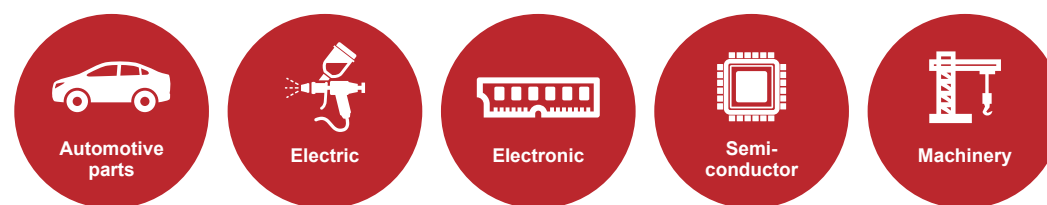

Specs

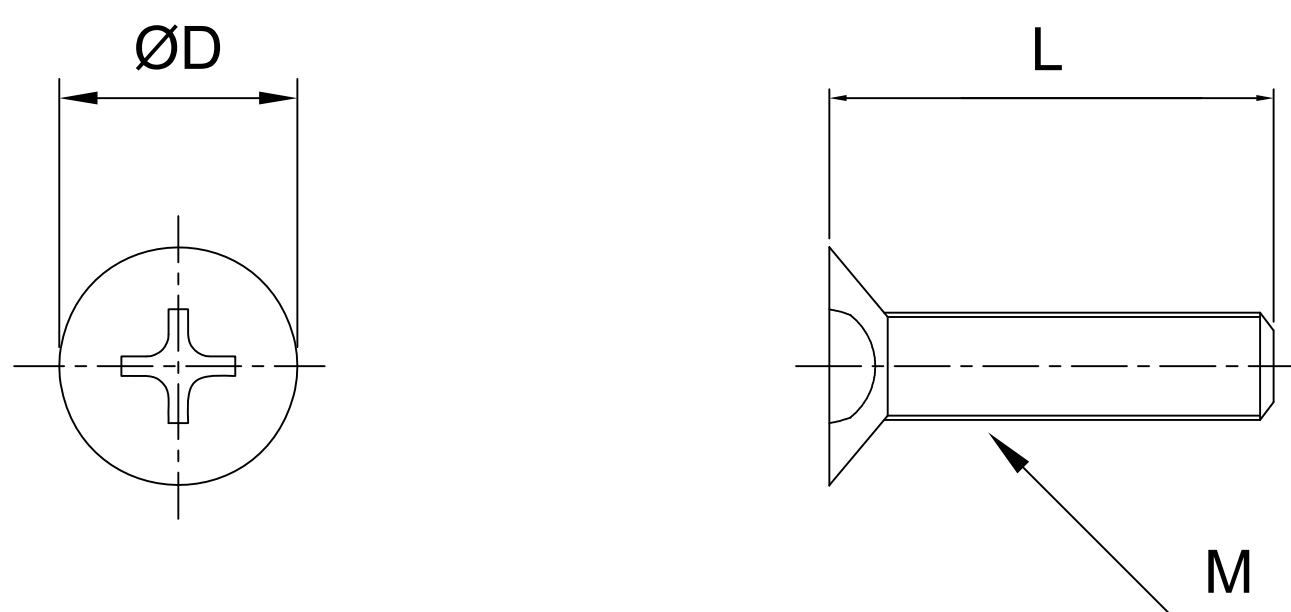

Model: SFHPPSM()-(L)

M	2	3	4	5	6	8
D	4	6	8	10	12	16
Pitch	0.4	0.5	0.7	0.8	1	1.25
4	•	•	-	-	-	-
5	•	•	•	-	-	-
6	•	•	•	-	-	-
8	•	•	•	•	-	-
10	•	•	•	•	•	•
12	-	•	•	•	•	•
15	-	•	•	•	•	•
16	-	•	•	•	•	•
20	-	•	•	•	•	•
25	-	•	•	•	•	•
30	-	-	•	•	•	•
35	-	-	•	•	•	•
40	-	-	•	•	•	•
45	-	-	-	-	•	•

Contact Information

No.60-3, Dongqi 7th Ln., Lukang Township, Changhua County 505008, Taiwan.
 TEL: +886-4-778-4688
 FAX: +886-4-778-4268
 E-mail: sales@plasautotw.com

