

Threaded Rod

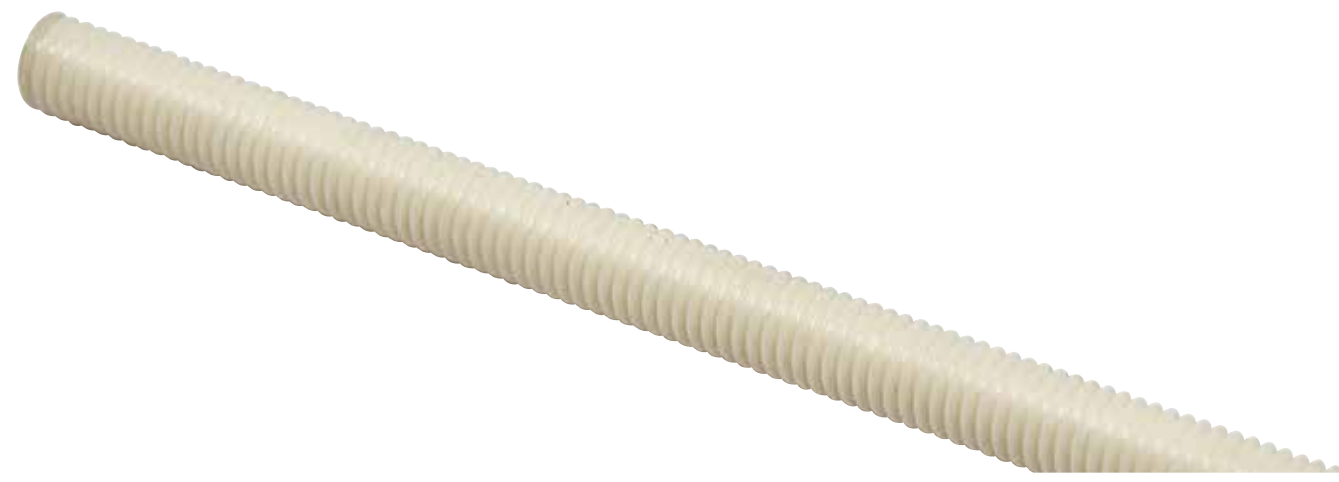

Model TRPPSM() -(L)

PPS Polyphenylene Sulfide / Advanced Engineering Plastics

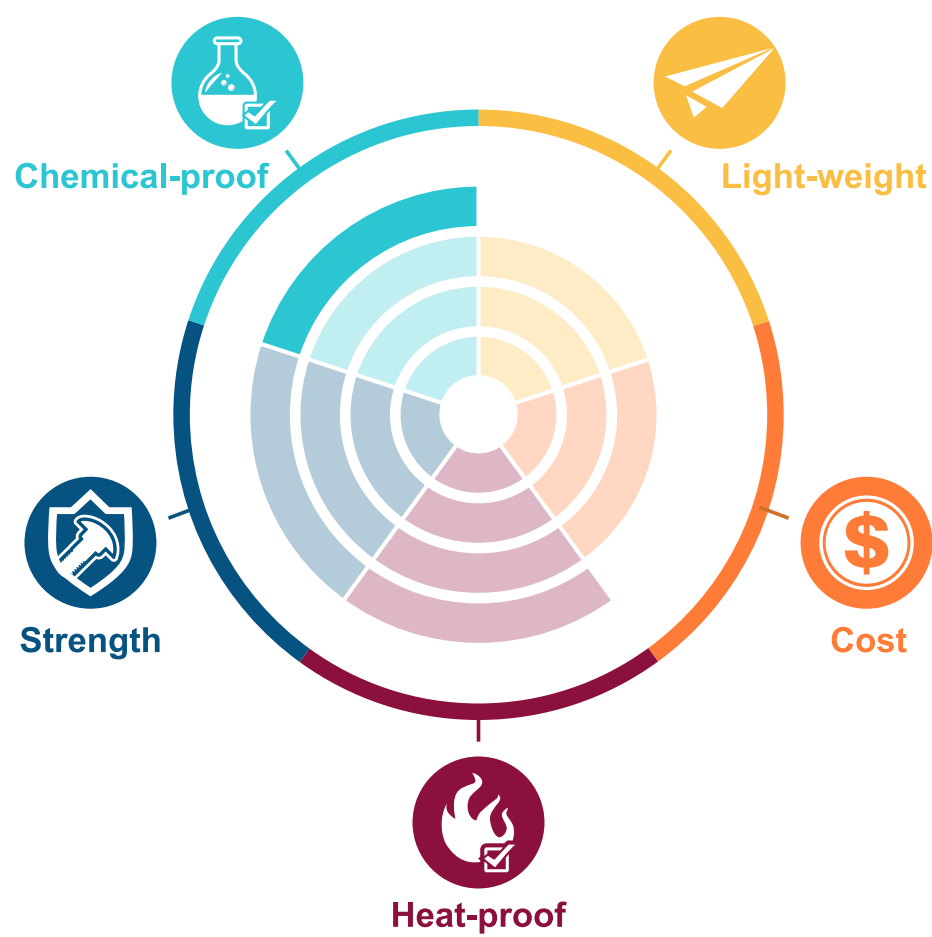

PPS is a kind of semi-crystalline, high-heat thermoplastic polymer that offers exceptional dimensional stability for precision-molded components needing to withstand prolonged, high-temperature service. Its inherently flame retardant and chemical resistance qualities make it competitive to PEEK and fluoropolymers.

Product Properties

1. Outstanding long-term heat resistance properties (200-240°C).
2. Minimum molding contraction rate and low moisture absorption.
3. Outstanding chemical resistance.
4. High mechanical strength and rigidity. Outstanding anti-fatigue and anti-creep properties.
5. Flame retardant (UL94V-0 without inclusion of flame retardant agents)
6. Offers outstanding electrical properties at high temperature, high humidity and high frequencies.

Applied industries



Specs

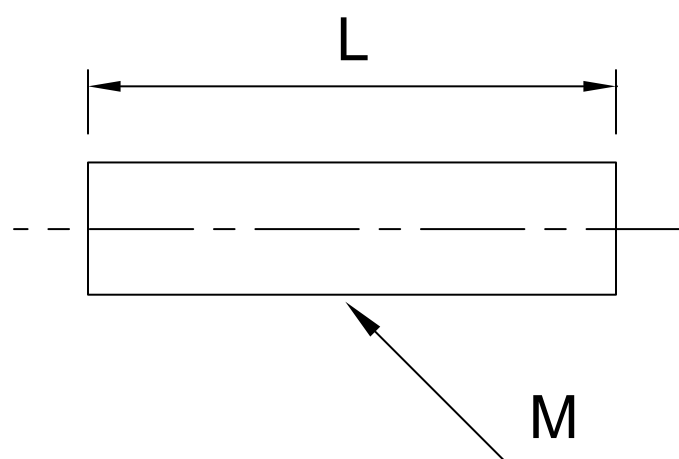

Model: TRPPSM() -(L)

M	5	6	8	10	12	3/8-16UNC
Pitch	0.8	1	1.25	1.5	1.75	1.5875
L(mm)	1000	●	●	●	●	●
	1500	-	●	●	●	●

For any demand of special sizes, please contact us!

Unit: mm

Contact Information

No.60-3, Dongqi 7th Ln., Lukang Township, Changhua County 505008, Taiwan.
 TEL: +886-4-778-4688
 FAX: +886-4-778-4268
 E-mail: sales@plasautotw.com

